

## ASSEMBLY INSTRUCTIONS FOR THE SE413 PROBE HOLDER

SY428 • November 2023.

### Step 1

Unpack the supplied parts. The parts are shown below in the scale of 1:3.

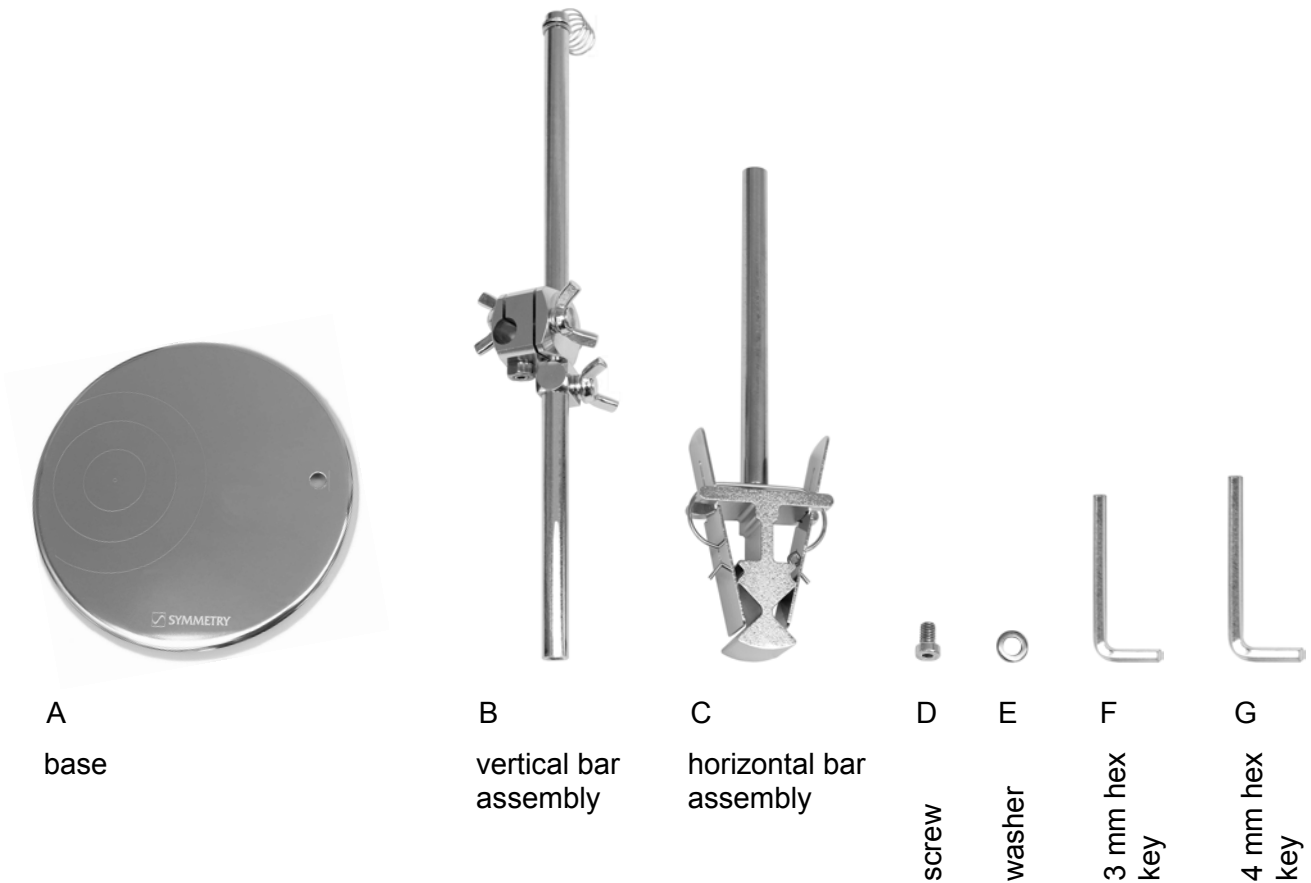

## Step 2

Place the base A on the edge of a table so that the hole in the base is free. Hold the vertical bar above the hole and its flat side parallel to the engraved line. Utilize screw D with washer E to fasten vertical rod assembly B on the base A. Use key G.

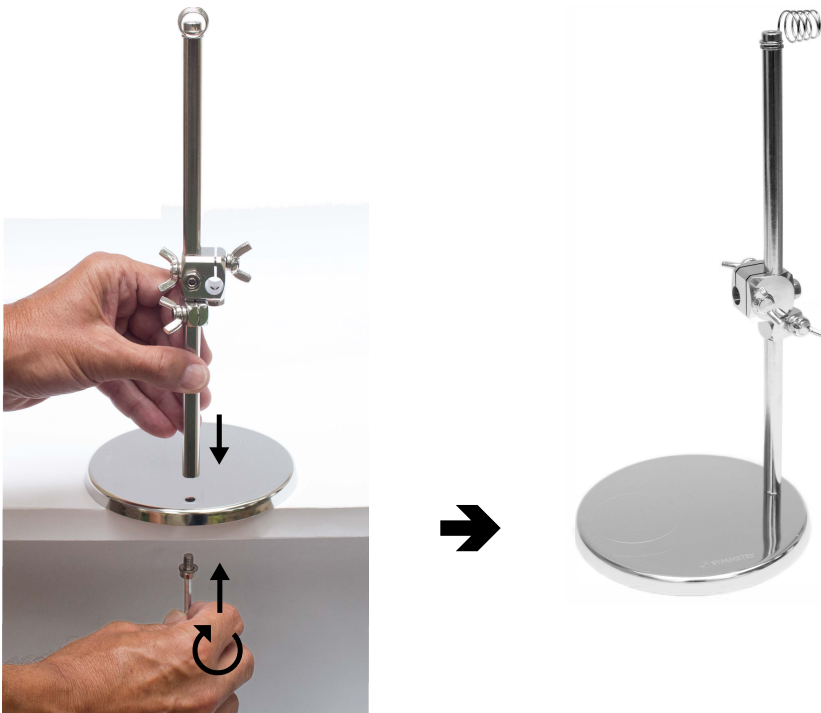

## Step 3

Fit the horizontal bar assembly C to the vertical bar assembly B. Face the flat side of the horizontal bar towards the base A. The wing screws fasten the horizontal bar position.

The probe holder is now mounted and ready for use.



GK 231124

